

3rd STREET

TEAM DROP OFF

TEAM OVER FLOW FOR QUIET STRETCHING

SOLOIST WARM-UP & PROPS

SOLOIST WARM-UP & PROPS

TEAM OVER FLOW FOR QUIET STRETCHING

98	A1	128	A2	128	A2	98	A1
----	----	-----	----	-----	----	----	----

98	A1	128	A2	128	A2	98	A1
----	----	-----	----	-----	----	----	----

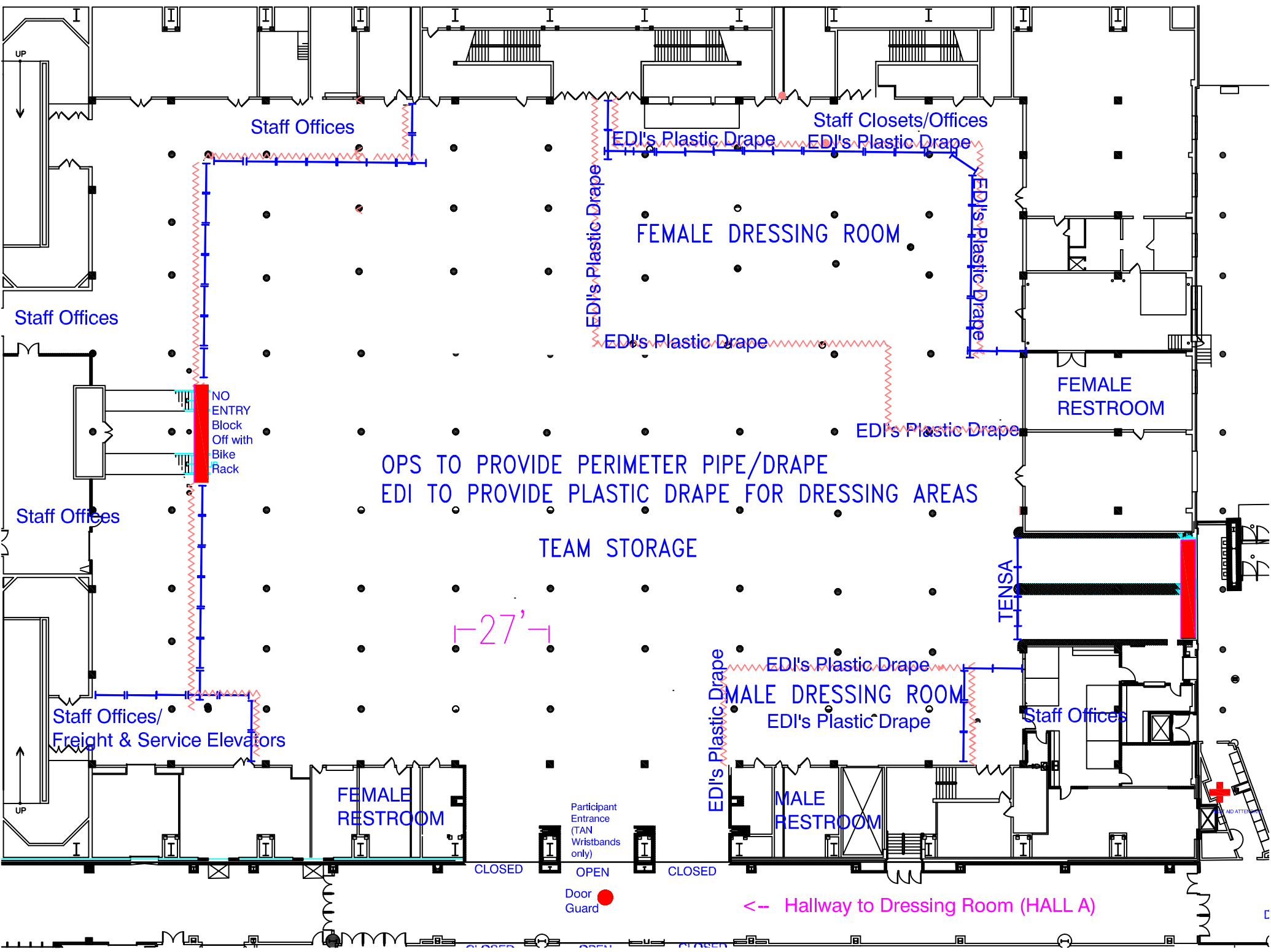

Staff Offices

Staff Closets/Offices

EDI's Plastic Drape

EDI's Plastic Drape

FEMALE DRESSING ROOM

EDI's Plastic Drape

EDI's Plastic Drape

EDI's Plastic Drape

EDI's Plastic Drape

OPS TO PROVIDE PERIMETER PIPE/DRAPE
EDI TO PROVIDE PLASTIC DRAPE FOR DRESSING AREAS

FEMALE RESTROOM

TEAM STORAGE

27'

TENZA

EDI's Plastic Drape

EDI's Plastic Drape

MALE DRESSING ROOM

EDI's Plastic Drape

Staff Offices

Staff Offices

NO ENTRY
Block Off with
Bike Rack

Staff Offices

Staff Offices/
Freight & Service Elevators

FEMALE RESTROOM

Participant Entrance
(TAN Wristbands only)

CLOSED

OPEN

CLOSED

Door Guard

← Hallway to Dressing Room (HALL A)

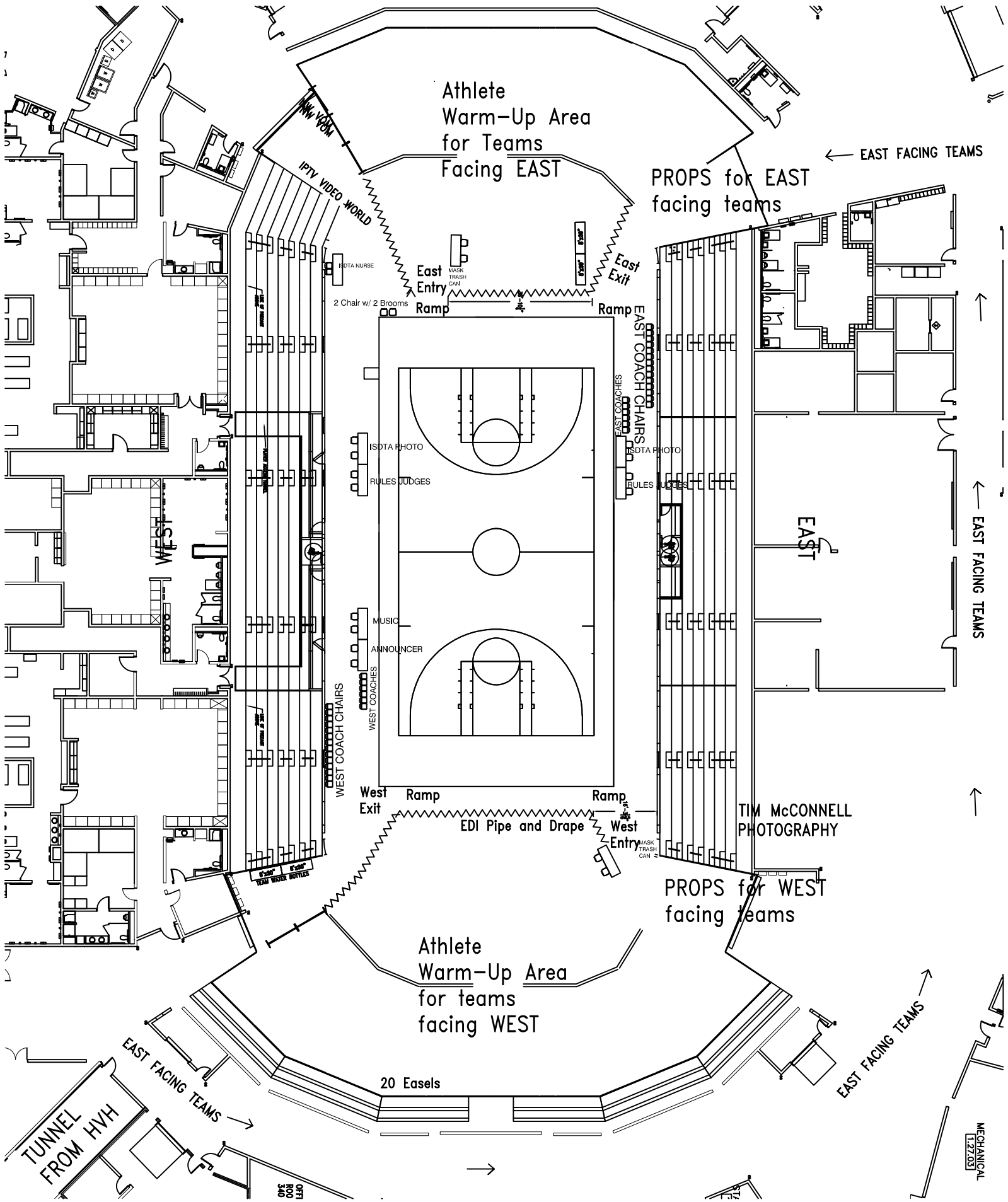

Athlete Warm-Up Area for Teams Facing EAST

PROPS for EAST facing teams

← EAST FACING TEAMS

ISDTA NURSE
2 Chair w/ 2 Brooms

East Entry

MASK TRASH CAN

East Exit

ISDTA PHOTO
RULES JUDGES

ISDTA PHOTO
RULES JUDGES

EAST

← EAST FACING TEAMS

MUSIC
ANNOUNCER
WEST COACHES
WEST COACH CHAIRS

EAST COACHES
EAST COACH CHAIRS

TIM McCONNELL PHOTOGRAPHY

West Ramp

Ramp

EDJ Pipe and Drape

West Entry

PROPS for WEST facing teams

Athlete Warm-Up Area for teams facing WEST

20 Easels

← EAST FACING TEAMS

TUNNEL FROM HVH
← EAST FACING TEAMS

MECHANICAL
1.27.03

OFF
ROD
340